

BLAIR BLANCHARD STAPLETON

LIMITED, REAL ESTATE BROKERAGE

INDUSTRIAL UNITS FOR LEASE

BBSREALTY.COM



\$15.00 PSF
NET LEASE RATE

\$5.53 PSF
T.M.I. (2026)

1,540-2,958
SQUARE FEET

53 Bittern Street, Ancaster, ON

Industrial units for lease in the Ancaster Business Park with great clear height and depth. Units have drive-in doors and are fully air-conditioned. Minutes to Highway 403. Public transit nearby, as well as commercial amenities.

Andrew Patrick Blair
Broker

Office: 905.529.5900 x 225
Email: blaird@bbsrealty.com

Alexandra Blair
Sales Representative

Office: 905.529.5900 x 213
Email: alexandrablair@bbsrealty.com



HAMILTON MAIN OFFICE

1425 Cormorant Road, Suite 303, Ancaster, ON, L9G 4V5
P 905.529.5900 F 905.529.7474

The information contained herein is provided by the building owner or their agents or representatives and although such information has been obtained from sources considered to be reliable, Blair Blanchard Stapleton Limited makes no representation or warranty as to the accuracy or completeness thereof. The information contained herein is subject to change without notice.

INDUSTRIAL UNITS FOR LEASE

Industrial units for lease in the Ancaster Business Park with great clear height & depth. Units have drive-in doors and are fully air-conditioned. Minutes to Highway 403. Public transit nearby, as well as commercial amenities.

DETAILS

NET LEASE RATE	\$15.00 psf
T.M.I. (2026)	\$5.53 psf
AIR CONDITIONING	yes
PARKING	surface
ZONING	M2 Exception 678

OPTIONS

UNIT	SQUARE FEET
1 & 2	2,958 sf
4	1,540 sf
10	1,540 sf
17	1,540 sf

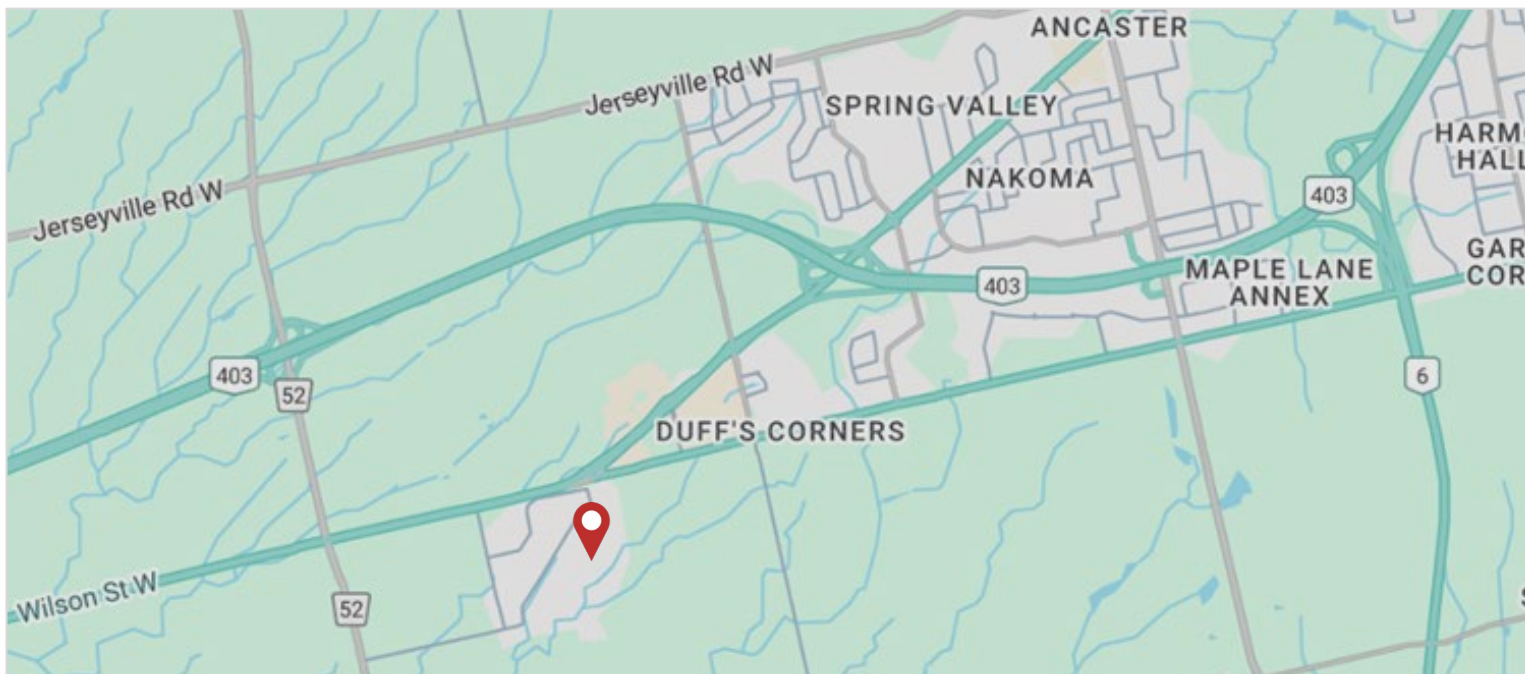
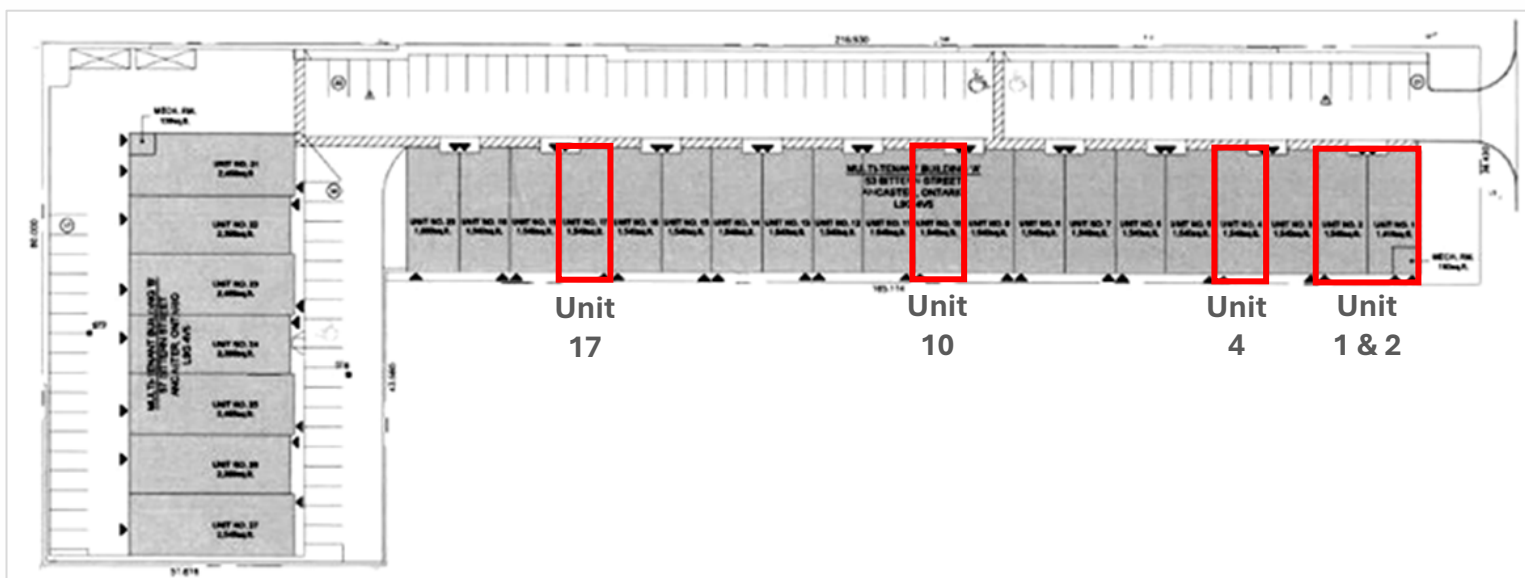

HAMILTON MAIN OFFICE

1425 Cormorant Road, Suite 303, Ancaster, ON, L9G 4V5
P 905.529.5900 F 905.529.7474

The information contained herein is provided by the building owner or their agents or representatives and although such information has been obtained from sources considered to be reliable, Blair Blanchard Stapleton Limited makes no representation or warranty as to the accuracy or completeness thereof. The information contained herein is subject to change without notice.

UNIT 1 & 2

Double front unit available at 53 Bittern Street in the Ancaster Business Park! Enjoy a fully air conditioned industrial unit that includes some office space. The unit has great clear height and depth, as well as two drive-in doors. The building has easy access to Hwy 403, and convenient public transit options. The Ancaster business park is situated close to local amenities like restaurants, retail shops, with great proximity to Hamilton and other key commercial areas.



UNIT 1 & 2

SIZE	2,958 sf
ELECTRIC	575 V / 200 A
CLEAR HEIGHT	24'
PARKING	(6) Surface
LOADING DOOR	(2) Drive In 10' x 12'
WASHROOMS	2

- Great clear height & depth
- Unit has two drive-in doors
- Fully air-conditioned
- Minutes to Highway 403
- Public transit nearby, as well as commercial amenities

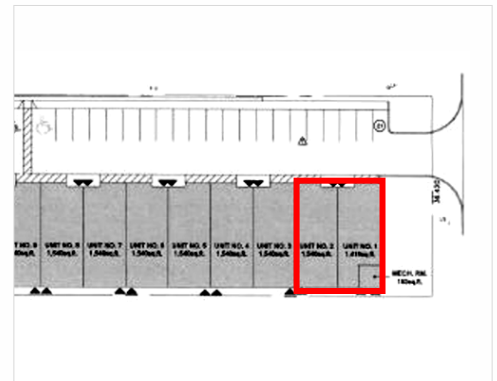

HAMILTON MAIN OFFICE

1425 Cormorant Road, Suite 303, Ancaster, ON, L9G 4V5
 P 905.529.5900 F 905.529.7474

The information contained herein is provided by the building owner or their agents or representatives and although such information has been obtained from sources considered to be reliable, Blair Blanchard Stapleton Limited makes no representation or warranty as to the accuracy or completeness thereof. The information contained herein is subject to change without notice.

UNIT 4

Small industrial unit available at 53 Bittern Street in the Ancaster Business Park! Enjoy a fully air conditioned industrial unit with great clear height and depth, as well as a drive-in doors. The building has easy access to Hwy 403, and convenient public transit options. The Ancaster business park is situated close to local amenities like restaurants, retail shops, with great proximity to Hamilton and other key commercial areas. Available immediately.



UNIT 4

SIZE	1,540 sf
ELECTRIC	575 V / 100 A
CLEAR HEIGHT	24'
PARKING	(3) Surface
LOADING DOOR	(1) Drive In 10' x 12'
WASHROOMS	1

- Great clear height & depth
- Unit has one drive-in door
- Fully air-conditioned
- Minutes to Highway 403
- Public transit nearby, as well as commercial amenities
- Available immediately

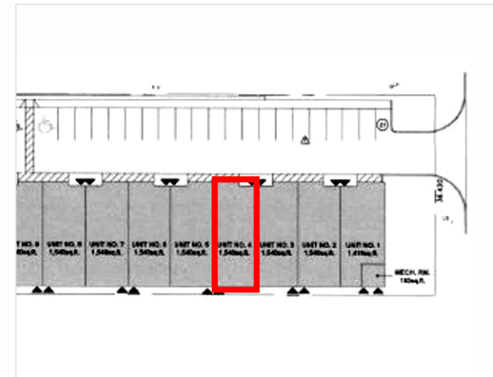

HAMILTON MAIN OFFICE

1425 Cormorant Road, Suite 303, Ancaster, ON, L9G 4V5
P 905.529.5900 F 905.529.7474

The information contained herein is provided by the building owner or their agents or representatives and although such information has been obtained from sources considered to be reliable, Blair Blanchard Stapleton Limited makes no representation or warranty as to the accuracy or completeness thereof. The information contained herein is subject to change without notice.

UNIT 10

Small industrial unit available at 53 Bittern Street in the Ancaster Business Park! Enjoy a fully air conditioned industrial unit with great clear height and depth, as well as a drive-in doors. The building has easy access to Hwy 403, and convenient public transit options. The Ancaster business park is situated close to local amenities like restaurants, retail shops, with great proximity to Hamilton and other key commercial areas. Available August 1, 2026.



UNIT 10

SIZE	1,540 sf
ELECTRIC	575 V / 100 A
CLEAR HEIGHT	24'
PARKING	(3) Surface
LOADING DOOR	(1) Drive In 10' x 12'
WASHROOMS	1

- Great clear height & depth
- Unit has one drive-in door
- Fully air-conditioned
- Minutes to Highway 403
- Public transit nearby, as well as commercial amenities
- Available August 1st, 2026

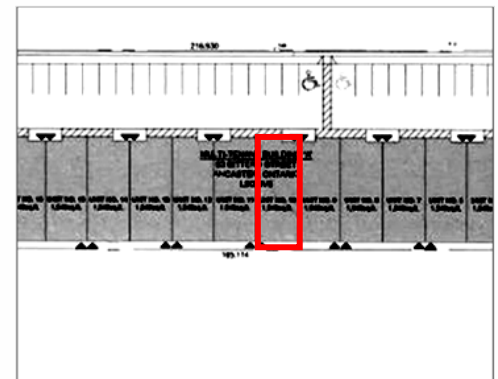

HAMILTON MAIN OFFICE

1425 Cormorant Road, Suite 303, Ancaster, ON, L9G 4V5
 P 905.529.5900 F 905.529.7474

The information contained herein is provided by the building owner or their agents or representatives and although such information has been obtained from sources considered to be reliable, Blair Blanchard Stapleton Limited makes no representation or warranty as to the accuracy or completeness thereof. The information contained herein is subject to change without notice.

UNIT 17

Small industrial unit available at 53 Bittern Street in the Ancaster Business Park! Enjoy a fully air conditioned industrial unit with great clear height and depth, as well as drive-in door. The building has easy access to Highway 403, and convenient public transit options. The Ancaster Business Park is situated close to local amenities such as restaurants, retail shops, with great proximity to Hamilton and other key commercial areas.



UNIT 17

SIZE	1,540 sf
ELECTRIC	575 V / 100 A
CLEAR HEIGHT	24'
PARKING	(3) Surface
LOADING DOOR	(1) Drive In 10' x 12'
WASHROOMS	1

- Great clear height & depth
- Unit has one drive-in door
- Fully air-conditioned
- Minutes to Highway 403
- Public transit nearby, as well as commercial amenities

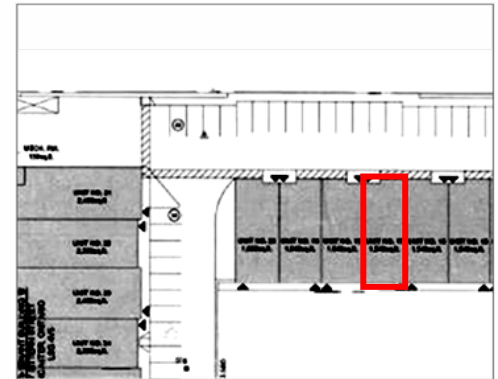

HAMILTON MAIN OFFICE

1425 Cormorant Road, Suite 303, Ancaster, ON, L9G 4V5
P 905.529.5900 F 905.529.7474

The information contained herein is provided by the building owner or their agents or representatives and although such information has been obtained from sources considered to be reliable, Blair Blanchard Stapleton Limited makes no representation or warranty as to the accuracy or completeness thereof. The information contained herein is subject to change without notice.